

mody ELECTRIC SUBMERSIBLE SEWAGE PUMP

MS 121 SERIES

SUBMERSIBLE
SEWAGE PUMPS
FOR
STATIONARY
WET PIT INSTALLATION
(P TYPE)
MOBILE WET PIT
INSTALLATION
(S TYPE)

.....

Model MS 121 - 2" Flange/Hose
(Med. Head - Med. Volume)

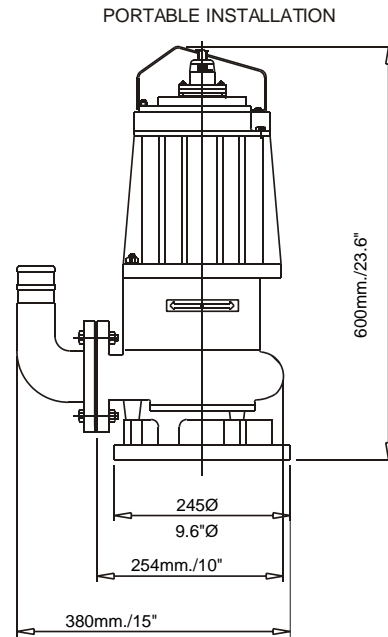
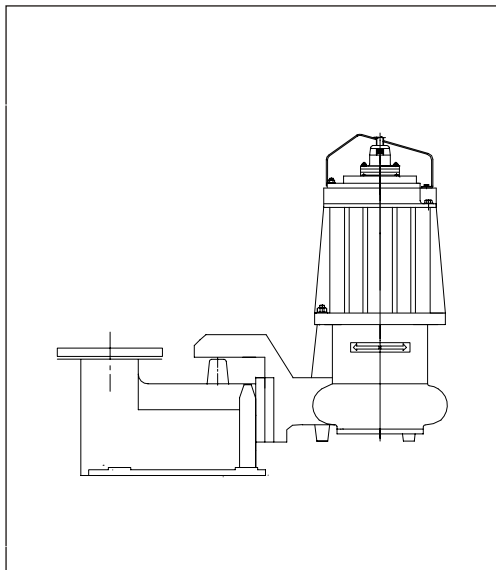

MS-121

STATIONARY (SEMI PERMANENT) WET PIT INSTALLATION

	A	B	C	D	E	F	G	H	J	K	M	N	O	P	R	S
MS 121	780	85	70	393	150	75	175	163	140	540	52	570	262	670	115	15

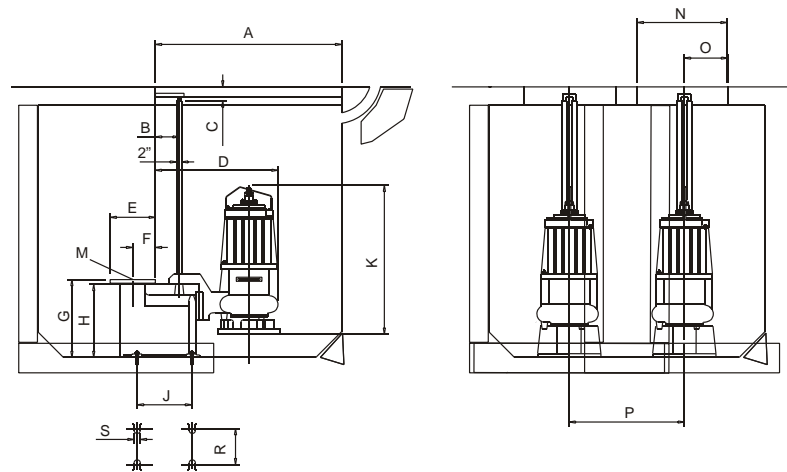

Mody Pumps Inc.
2166 Zeus Court, Bakersfield, CA 93308. USA
Tel.: (661) 392-7600 • Fax: (661) 392-7601
<http://www.modypump.com>
E-mail: sales@modypump.com

mody ELECTRIC SUBMERSIBLE SEWAGE PUMP

MS 121

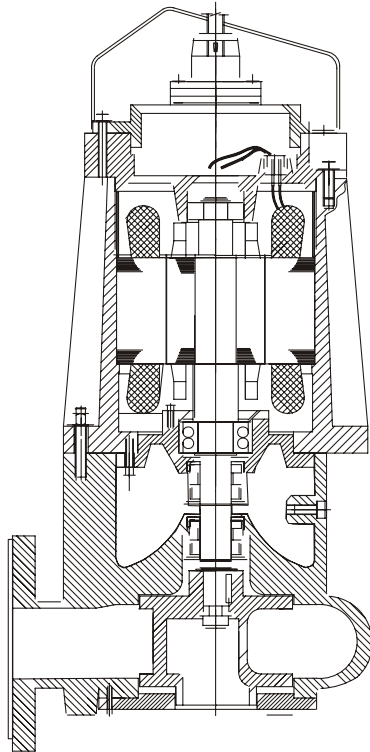

PERFORMANCE CURVE

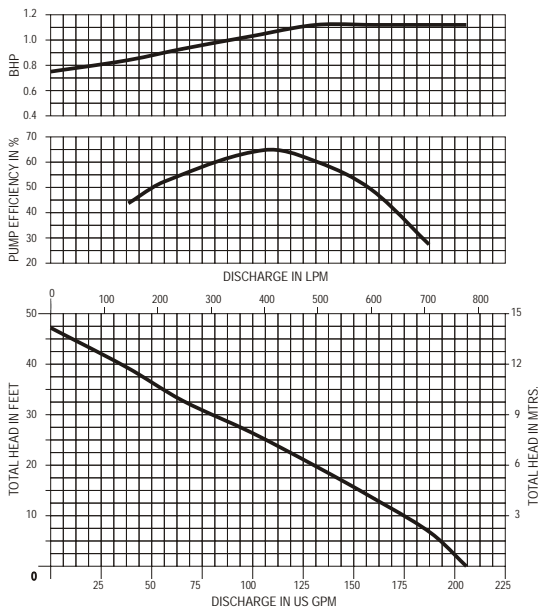

MS 121

MATERIALS OF CONSTRUCTION AND ENGG. DATA SPECIFICATIONS:

MODEL	MS 121
HP/kW	2/1.5
RPM 60Hz/50Hz	3550/2800
Max.Amps (460 Volts)	2.4
Solid Handling	1.5"/35mm
Weight-P Type(approx.) - lbs/Kgs.	137/62
Weight-S Type(approx.) - lbs/Kgs.	117/53
Impeller Type	Channel
Max. Temp. of Pumped Fluid:	104°F/40°C
Max. Starts/Stop Per Hour:	15
Max. Submergence:	35'/10 Metres

MOTOR

2 Pole continuous rated motor with squirrel cage rotor. Bi-metallc switches embedded in stator winding to protect against overheating. Stator insulation class "F".

POWER SUPPLY

208/230/380/415/440/575 Volts +/-6%, 3 Phase, 50/60 Hz AC Supply. Available in any voltage and frequency combination.

BALL BEARINGS

The rotor shaft is carried in two ball bearings. The lower bearing is a double row angular contact bearing capable of carrying high thrust and radial loads. The upper bearing is a deep groove single row ball bearing. The bearings are filled with high temperature grease containing special anti-corrosive additive with no maintenance required for life.

POWER CABLE

Water/oil resistant EPR insulated, copper conductor flexible cable, 14/4 SOOW. 50' length, 6 core cable available with optional thermal overloads.

SHAFT SEALS

Extremely compact Tandem Tungsten Carbide/Tungsten Carbide Upper & Lower Mechanical seals minimize shaft overhang and deflection thus maximizing mean time between service intervals.

HYDRAULICS

Single channel impellers, Hydrodynamically balanced with improved flow pattern contribute to a virtually clog-free pump. Computerised design resulting in high efficiency and low running costs. Smooth contoured volute design ensuring low head losses.

COOLING

Integral cast cooling fins on motor casing with large surface area ensure efficient heat dissipation and low temperature rise. Shrink fitted stators and short shaft overhang facilitate efficient cooling.

MATERIALS OF CONSTRUCTION

Description	Material
Stator casing	Cast Iron
Pump Casing	Cast Iron
Impellers	Cast Iron
Shaft	St. Steel
Hardware	St. Steel
Mech.Seals	TC V/S TC
"O" Rings	Nitrile rubber

SURFACE TREATMENT

Primer with Epoxy and subsequently coated with black chloric paint for max. corrosion protection.

Due to product development, specifications may be subject to change without notice.

PORTABLE INSTALLATION

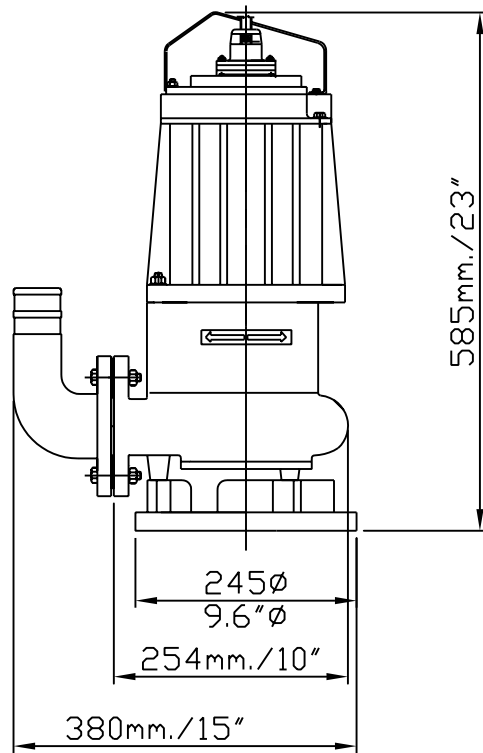

MS-121

STATIONARY (SEMI PERMANENT) WET PIT INSTALLATION

	A	B	C	D	E	F	G	H	J	K	MØ	N	□	P	R	S
MS121	780	85	70	393	150	75	175	163	140	540	52	570	262	670	115	15

